

CIRCUIT DIAGRAM
回路图

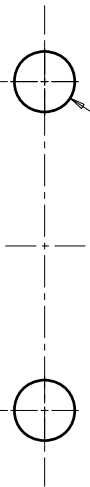
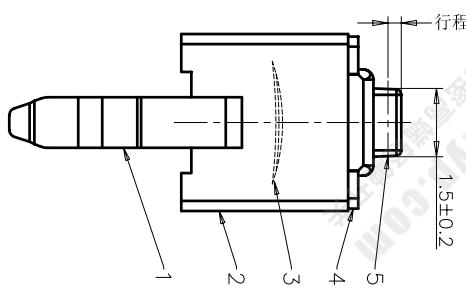

RECOMMENDED P.C.B. LAYOUT
安装尺寸图

规格 Specifications

额定负荷 Rating	DC 12V/50mA
接触电阻 Contact Resistance	100mΩ max.
绝缘电阻 Insulation resistance	DC100V 60S 100MΩ min.
抗电强度 Dielectric strength	AC250V(50-60HZ) 60S min.
操作力 Operation force	≤180±30gf ≤300±50gf
寿命试验 Operating Life	50,000 cycles 30,000 cycles
行程 Travels	0.25±0.1mm

REV	ECN NO.	APPD
A	HC-11-0023	PRIOJOM
B	HC-11-0060	PRIOJOM
C	HC-12-0059	PRIOJOM
D	HC-15-0060	PRIOJOM

PRODUCT NO.: 1TS002*****-CT

- 轻触开关
- 3X6系列
- 外形:
 - A=插脚
 - B=贴片
 - C=贴片带柱
 - E=贴片2.5高
 - K=贴片带柱8.8
 - L=贴片10.2
- 按钮颜色: []
- 底座颜色: []
- 盖板颜色: []
- 操作力度:
 - 130=130±20gf
 - 160=160±30gf
 - 180=180±30gf
 - 220=220±40gf
 - 250=250±50gf
 - 300=300±50gf
- 手感:
 - 0=常规
 - 1=大手感
 - 2=小手感
 - 3=特殊手感
- 材质:
 - 0=PA66
 - 1=LCP+PPA
 - 2=LCP
 - 3=PA66+PPA
 - 4=新增材质
- 编带
非编带, 不启用
- 产品高度(H):
 - 430=4.3mm
 - 500=5.0mm

ITEM	PART NAME	QUANTITY	MATERIAL	FINISH
5	ACTUATOR	1	PA66	WHITE
4	COVER	1	STAINLESS STEEL	NATURAL
3	DOME	1	STAINLESS STEEL	Ag-PLATED
2	HOUSING	1	PA66	WHITE
1	TERMINAL	1	BRASS	Ag-PLATED/0.2μm

UNITS	MM
X. ± 0.3	X' ± 3'
.X ± 0.2	.X' ± 2'
.XX ± 0.1	.XX' ± 1'
.XXX ± 0.05	.XXX' ± 0.5'

NAME(INTENDED USE)	3X6 T/H SERIES TACT SWITCH
PART NO.(INTENDED USE)	1TS002A****-****-****0
APPD:	ZO 2015/11/13
CHKD:	M.H.Li 2015/11/13
DR:	WP.Liu 2015/11/12
TITLE:	PRODUCT DRAWING
DWG NO.:	1TS002A

SCALE	10/1
SHEET	1/4
REV.	D

THESE DRAWINGS AND SPECIFICATIONS ARE THE PROPERTY OF HON YUAN PRECISION IND. CO., LTD. AND SHALL NOT BE REPRODUCED, COPIED, OR TRANSMITTED IN ANY FORM OR BY ANY MEANS WITHOUT THE PRIOR WRITTEN CONSENT OF HON YUAN PRECISION IND. CO., LTD.