

NON-INSULATED HEAVY DUTY (HD SERIES) SPADE TERMINALS

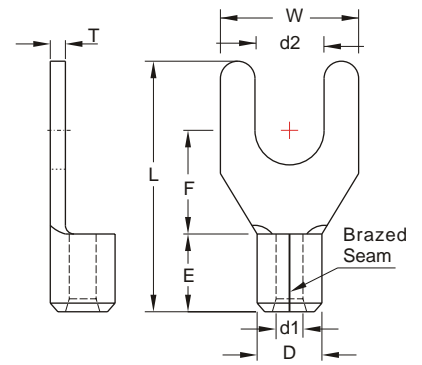

MAXIMUM ELECTRIC CURRENT:

A.W.G.	16	14
AMP.	18	30

TERMINAL MATERIAL: COPPER

WIRE RANGE A.W.G. mm ²	ITEM NO.		STUD SIZE	DIMENSION ^{inch} / _{mm}							CRIMPING TOOL	Q'TY BOX	
	BRAZED SEAM	BUTTED SEAM	d2	W	F	L	E	D	d1	T			
16-14 A.W.G.	SNBS2-3.7-HD*	SNS2-3.7-HD*	#6	.146 3.7	.283 7.2	.295 7.5	.685 17.4	.236 6.0	.220 5.6	.110 2.8	.051 1.3	IZUMI MODEL 5 OR K.S. MODEL KST2000D-1322 NO:12-10 OR LY-2045A LY-2045C LY-2045D WITH DIE INDEX NO:5.5	1000
	SNB2-3.7-HD	SN2-3.7-HD	#6	.146 3.7	.327 8.3	.276 7.0	.728 18.5						1000
	SNBSS2-4-HD*	SNSS2-4-HD*	#8	.169 4.3	.283 7.2	.295 7.5	.685 17.4						1000
	SNBS2-4-HD*	SNS2-4-HD*	#8	.169 4.3	.327 8.3								1000
1.5-2.5 mm ²	SNBL2-4-HD	SNL2-4-HD	#8	.169 4.3		.276 7.0	.720 18.3						1000
	SNB2-5-HD	SN2-5-HD	#10	.209 5.3	.354 9.0								1000
	SNBS2-6-HD	SNS2-6-HD	1/4	.252 6.4									1000
	SNBL2-6-HD*	SNL2-6-HD*	1/4	.252 6.4	.472 12.0	.472 12.0	.965 24.5						1000
	SNB2-8-HD	SN2-8-HD	5/16	.331 8.4	.551 14.0	.413 10.5	.925 23.5	1000					

* : DEVELOPING ON DEMAND