

REV.	ECN. NO.	APPD.
A		

SPECIFICATIONS

Current Rating: 1A AC, DC
Voltage Rating: 250V AC, DC
Temperature Range: -25°C ~ +130°C
Contact Resistance: 20mΩ Max
Insulation Resistance: 1000MΩ Min
Withstanding Voltage: 1000V AC/minute
Material
Wafer: PA9T UL94V-0
PIN: C2680 Tin-plated
Fixed piece: C2680 Tin-plated

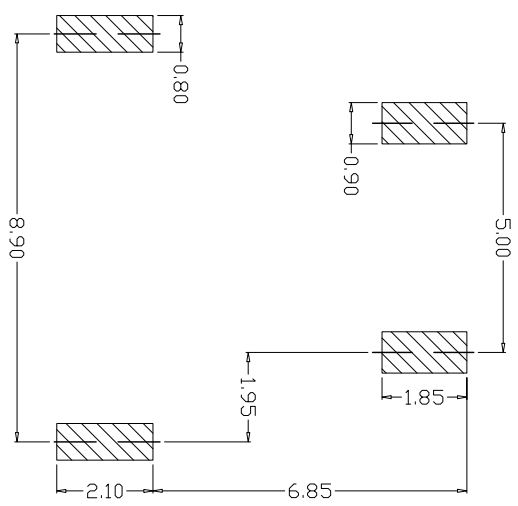
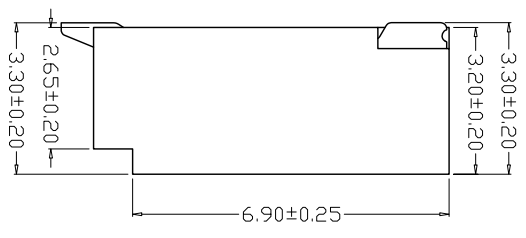
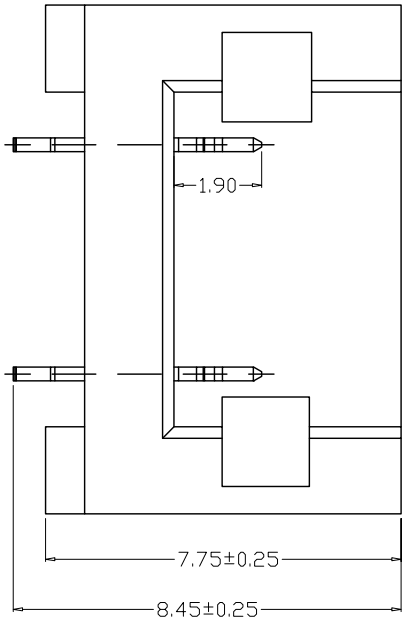
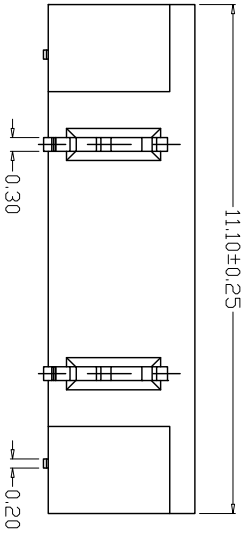
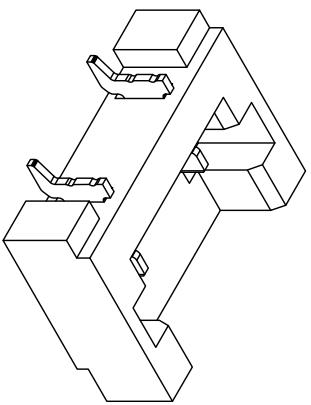

PCB LAYOUT

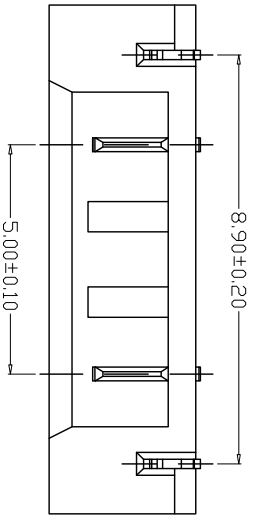

X. ±0.30	X.° ±5°	UNITS	mm	NAME (INTENDED USE)	MINTRON CO., LTD.
.X ±0.20	.X° ±2°	MATL		PART NO. (INTENDED USE)	
.XX ±0.10	.XX° ±1°	FINISH		TITLE:	
.XXX ±0.05	.XXX° ±0.5°	QTY		DWG NO.:	
FLAT CABLE CONNECTOR				APPD: SUNNY	MT5001-02A
				CHKD: USA	
				DR: ZOE	2023-06-16

SCALE	SHEET	REV.
1/1	1/1	A