

REV.	DATE	DESCRIPTION
NC	10/29/02	INITIAL RELEASE

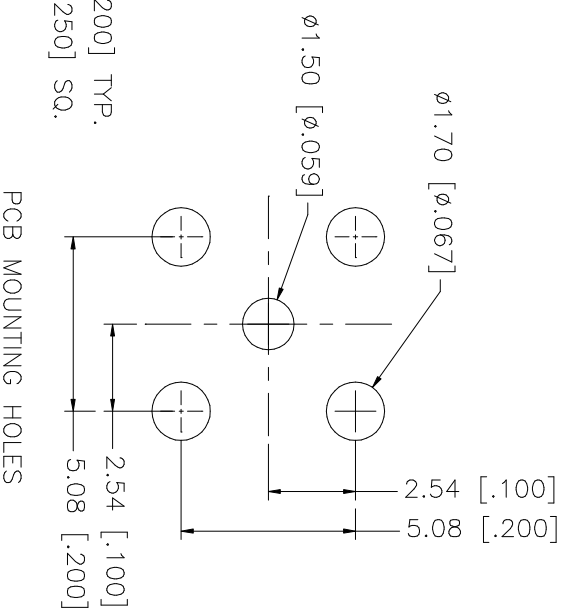
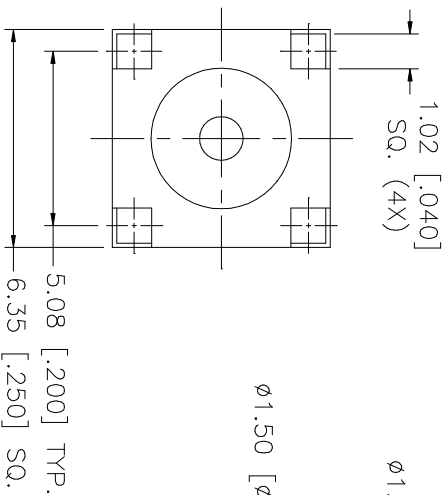
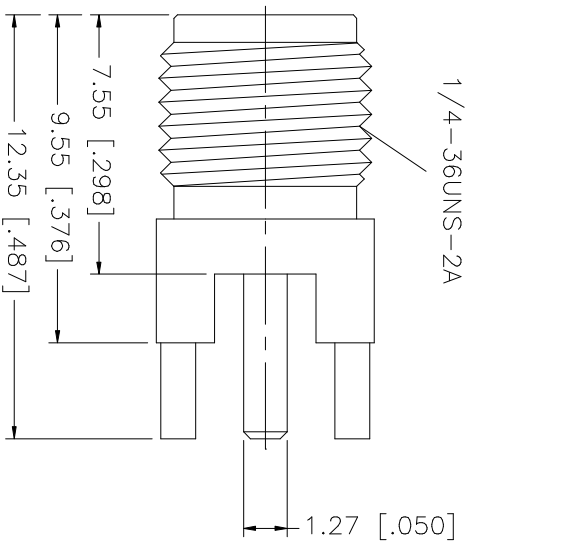

8				UNLESS OTHERWISE SPECIFIED DIMENSIONS ARE IN MILLIMETERS	APPROVALS	DATE	TITLE			REV.
7				DIMENSIONS IN [] ARE IN INCHES FOR CUSTOMER REFERENCE ONLY	DRAWN	10/29/02	SMA P.C.B. JACK EXTENDED LEGS			NC
6					CHECKED		Amphenol - Connex CONNECTOR CORPORATION			
5					ISSUED		SMA P.C.B. JACK EXTENDED LEGS			
4				UNLESS OTHERWISE SPECIFIED TOLERANCES FOR INCHES ARE:			SIZE	FSCM NO.	DWG. NO.	
3	CONTACT PIN	BER. COPPER	GOLD	.XXX = ± 0.005"			A	99001	132134-11	132134-11.DWG
2	INSULATOR	TEFLON	NATURAL	.XX = ± 0.010"			SCALE	PART NO.	SHEET	OF
1	BODY	BRASS	GOLD	.X = ± 0.020"			NA	132134-11	1	1
	DESCRIPTION	MATERIAL	FINISH	DO NOT SCALE DRAWING						

Mouser Electronics

Authorized Distributor

Click to View Pricing, Inventory, Delivery & Lifecycle Information:

[Amphenol:](#)

[132134-11](#)