

High Density D-Sub Surface Mount 15 position Female Type

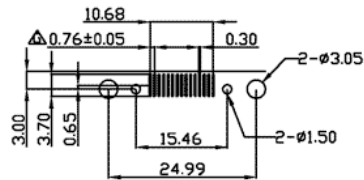

Pin Number :
6 11 1 7 12 2 8 13 3 9 14 4 10 15 5
Recommended PCB Layout

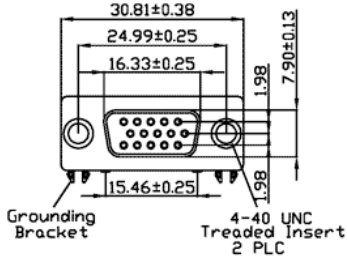
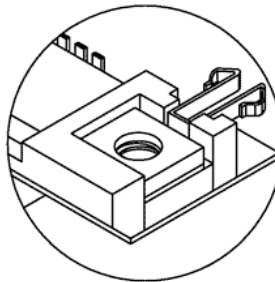
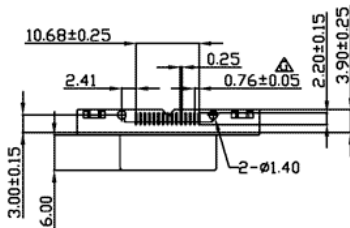
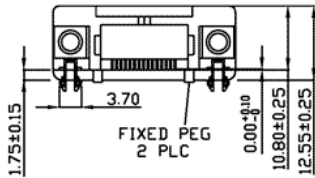

Fork Board Lock Type

Material And Finish	
Shell	Steel tin plated over nickel
Bracket	Brass strip -H nickel plated
Screw	Brass nickel plated
Insulator	Nylon 6T Fiber reinforced UL - 94VO, Color black
Contact Material (socket)	Phosphor bronze Duplex Plated As Follows: A - 30μ" gold on mating area. Tin plated over nickel on termination area. B - 15μ" gold on mating area. Tin plated over nickel on termination area. C - Gold flash on mating area. Tin plated over nickel on termination area.
Specifications	
Rated Current	3A
Rated Voltage	300V DC
Withstanding Voltage	500V(r.m.s) AC for 1 minute
Insulation Resistance	more than 1000M ohm at 500V DC
Contact Resistance	13M ohm Max.
Dielectric Strength	1000V AC Min. for 1 minute
Temperature	-55 °C ~ +105 °C

Part Numbers

Part Number	Duplex Plated
-------------	---------------

33DSMT1-E15SNAT	30 μ " gold on mating area. Tin plated over nickel on termination area.
33DSMT1-E15SNBT	15 μ " gold on mating area. Tin plated over nickel on termination area.
33DSMT1-E15SNCT	Gold flash on mating area. Tin plated over nickel on termination area.