

ASSEMBLY PART NUMBER	COLOR	KEYING OPTION	CPA	CLIPSLOT	TOOLED
34062-0001	BLACK	A	NO	NO	YES
34062-0002	GRAY	B	NO	NO	YES
34062-0003	BLACK	C	NO	NO	YES
34062-0004	BLACK	D	NO	NO	YES
34062-0005	BLACK	A	YES	NO	YES
34062-0006	GRAY	B	YES	NO	YES
34062-0007	BLACK	C	YES	NO	YES
34062-0008	BLACK	D	YES	NO	YES
34062-0009	GRAY	D	NO	NO	YES
34062-0010	GRAY	D	YES	NO	YES
34062-0011	BLACK	A	NO	YES	YES
34062-0012	GRAY	B	NO	YES	NO
34062-0013	BLACK	C	NO	YES	NO
34062-0014	BLACK	D	NO	YES	NO
34062-0015	BLACK	A	YES	YES	YES
34062-0016	GRAY	B	YES	YES	NO
34062-0017	BLACK	C	YES	YES	NO
34062-0018	BLACK	D	YES	YES	NO
34062-0019	GRAY	D	NO	YES	NO
34062-0020	GRAY	D	YES	YES	NO

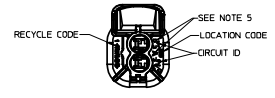
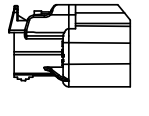
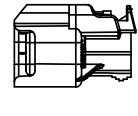
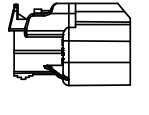
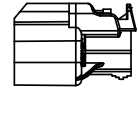
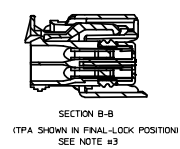
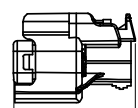
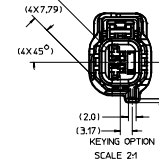
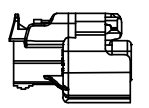
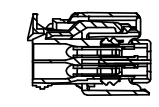
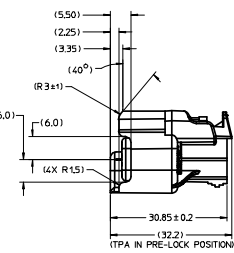
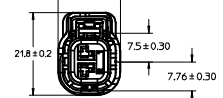
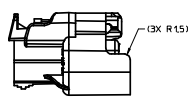
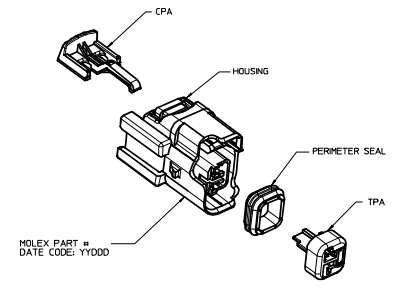
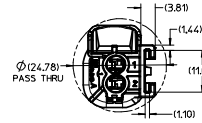
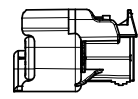
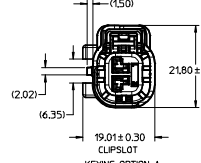
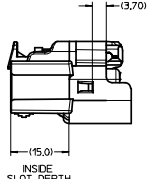
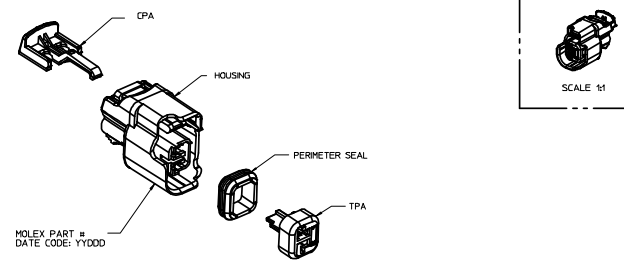
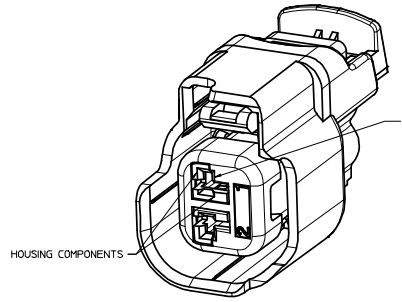
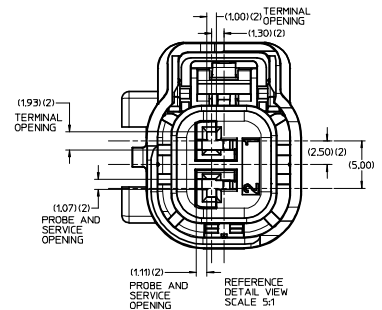

- NOTES: UNLESS OTHERWISE SPECIFIED
- ASSEMBLY CONFORMS TO:  
SAE/USCAR-12, REV 2.  
SAE/USCAR-2, REV 4.  
EXCEPT TPA REMOVAL FROM FINAL LOCK - SECOND CYCLE.  
SHALL NOT BE LESS THAN 12 NEWTONS  
SAE/USCAR-20 DEC. 2001.
  - DESIGNED TO MATE WITH DEVICE CONNECTION AS SPECIFIED IN EWCAP DRAWING 550-5-002-1-201 REV A 19-18-2003.
  - ASSEMBLY SHIPPED WITH TPA IN PRE-LOCK POSITION (SEE SECTION B-B PRE-LOCK). UPON FULL TERMINAL ASSEMBLY, EACH TPA MUST BE SNAPPED INTO ITS FINAL-LOCK POSITION.
  - OPTIONAL CPA SHOWN IN ALL VIEWS. SEE TABLES FOR SPECIFIC ASSEMBLY OPTION AND NUMBER.
  - KEYING OPTION AND ASSEMBLY MACHINE IDENTIFIER.
  - RECYCLE CODE FOR PERIMETER SEAL: SILICON 50 DUROMETER  
HOUSING: PPE/PA-GF30  
TPA/CPA: PBT-GF30
  - SYSTEM TESTED USING ESB-HL123-A, 16/18, 20/22 AWG WIRE. MS-8288 AND MS9502 ARE ACCEPTABLE ALTERNATIVES.

AWG	METRIC	PREFERRED TERMINAL	OPTIONAL TERMINAL	PAYOFF DIRECTION	PLATING	GRP	YAZAKI P/N	WIRE OD RANGE	COLOR	OSR P/N	WIRE OD RANGE	COLOR
22	0.50	34083-2003	34083-0003	RIGHT	TIN	22	7158-3030-50	1.20-1.70	RED	E-1644-01	1.19-1.65	PINK
22	0.50	34083-3003	34083-1003	LEFT	TIN	22	7158-3030-50	1.20-1.70	RED	E-1644-01	1.19-1.65	PINK
22	0.50	34081-2005	34081-0005	RIGHT	GOLD	22	7158-3030-50	1.20-1.70	RED	E-1644-01	1.19-1.65	PINK
22	0.50	34081-3005	34081-1005	LEFT	GOLD	22	7158-3030-50	1.20-1.70	RED	E-1644-01	1.19-1.65	PINK
20	0.75	34083-2002	34083-0002	RIGHT	TIN	18/20	7158-3031-90	1.63-2.40	BLUE	E-1644-00	1.60-2.10	GREEN
20	0.75	34083-3002	34083-1002	LEFT	TIN	18/20	7158-3031-90	1.63-2.40	BLUE	E-1644-00	1.60-2.10	GREEN
20	0.75	34081-2004	34081-0004	RIGHT	GOLD	18/20	7158-3031-90	1.63-2.40	BLUE	E-1644-00	1.60-2.10	GREEN
20	0.75	34081-3004	34081-1004	LEFT	GOLD	18/20	7158-3031-90	1.63-2.40	BLUE	E-1644-00	1.60-2.10	GREEN
18	1.0	34083-2002	34083-0002	RIGHT	TIN	18/20	7158-3031-90	1.63-2.40	BLUE	E-1644-00	1.60-2.10	GREEN
18	1.0	34083-3002	34083-1002	LEFT	TIN	18/20	7158-3031-90	1.63-2.40	BLUE	E-1644-00	1.60-2.10	GREEN
18	1.0	34081-2004	34081-0004	RIGHT	GOLD	18/20	7158-3031-90	1.63-2.40	BLUE	E-1644-00	1.60-2.10	GREEN
18	1.0	34081-3004	34081-1004	LEFT	GOLD	18/20	7158-3031-90	1.63-2.40	BLUE	E-1644-00	1.60-2.10	GREEN
16	1.5	34083-2001	34083-0001	RIGHT	TIN	14/16	7158-3031-90	1.63-2.40	BLUE	E-1644-02	2.10-2.50	YELLOW
16	1.5	34083-3001	34083-1001	LEFT	TIN	14/16	7158-3031-90	1.63-2.40	BLUE	E-1644-02	2.10-2.50	YELLOW
16	1.5	34081-2003	34081-0003	RIGHT	GOLD	16	7158-3031-90	1.63-2.40	BLUE	E-1644-02	2.10-2.50	YELLOW
16	1.5	34081-3003	34081-1003	LEFT	GOLD	16	7158-3031-90	1.63-2.40	BLUE	E-1644-02	2.10-2.50	YELLOW

<b>ENTER DESCRIPTION</b> EC NO. UAU2008-063Z DRAWING/REV/DATE/APP/3-SHARE/REV/2003/04/08 REV. DESCRIPTION	<b>QUALITY SYMBOLS</b> 0 0	<b>GENERAL TOLERANCES (UNLESS SPECIFIED)</b> mm INCH		<b>DIMENSION STYLE</b> MM ONLY		SCALE 2:1	DESIGN UNITS METRIC	THIRD ANGLE PROJECTION
		4 PLACES ± --- ± --- 3 PLACES ± --- ± --- 2 PLACES ± 0.1 ± --- 1 PLACE ± 0.3 ± --- ANGULAR ± 3°	DRAWN BY L.P.LIM DATE 2002/11/15 CHECKED BY DKOEHLER DATE 2002/11/25 APPROVED BY SPENDLET DATE 2002/11/25	TITLE <b>CONNECTOR ASSEMBLY          2-WAY FUEL 15MM FEMALE          FUEL INJECTOR CONNECTOR</b>		MATERIAL NO. SD-34062-001 DOCUMENT NO.		SHEET NO. 4 OF 1
DRAFT WHERE APPLICABLE MUST REMAIN WITHIN DIMENSIONS		SEE TABLE						

ASSEMBLY PART NUMBER	COLOR	KEYING OPTION	CPA	CLIP-SLOT
34062-0021	BLACK	A	NO	NO
34062-0022	LT. GRAY	B	NO	NO
34062-0023	BLACK	C	NO	NO
34062-0024	BLACK	D	NO	NO
34062-0029	LT. GRAY	D	NO	NO
34062-0025	BLACK	A	YES	NO
34062-0026	LT. GRAY	B	YES	NO
34062-0027	BLACK	C	YES	NO
34062-0028	BLACK	D	YES	NO
34062-0030	LT. GRAY	D	YES	NO
34062-0031	BLACK	A	NO	YES
34062-0032	LT. GRAY	B	NO	YES
34062-0033	BLACK	C	NO	YES
34062-0034	BLACK	D	NO	YES
34062-0035	LT. GRAY	D	NO	YES

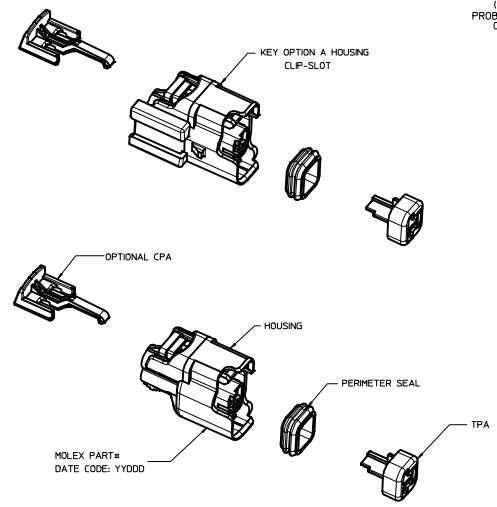
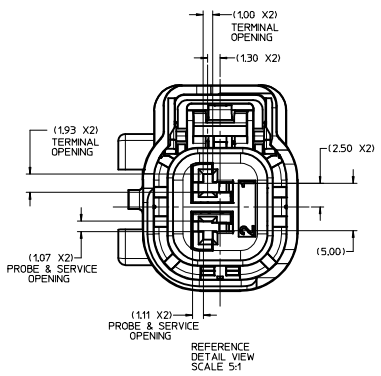

NOTES: UNLESS OTHERWISE SPECIFIED  
 1. ASSEMBLY CONFORMS TO:  
 SAE/USCAR-12, REV 2;  
 SAE/USCAR-2 REV 4;  
 a) EXCEPT TPA REMOVAL FROM FINAL LOCK - SECOND CYCLE SHALL NOT BE LESS THAN 12 NEWTONS.  
 SAE/USCAR-20 DEC 2001  
 b) POLARIZATION FEATURE EFFECTIVENESS: CONFORMS TO USCAR-2 REV 5  
 2. DESIGNED TO MATE WITH DEVICE CONNECTION AS SPECIFIED IN EWCAP DRAWING 150-S-002-1-Z01 REV A (9-18-2003).  
 3. ASSEMBLY SHIPPED WITH TPA IN PRE-LOCK POSITION (SEE SECTION A-A PRE-LOCK). UPON FULL TERMINAL ASSEMBLY, EACH TPA MUST BE SNAPPED INTO ITS FINAL-LOCK POSITION (SEE SECTION A-A FINAL-LOCK)  
 4. OPTIONAL CPA IN PRE-LOCK POSITION SHOWN IN ALL VIEWS.  
 5. KEYING OPTION AND ASSEMBLY MACHINE IDENTIFIER.  
 6. RECYCLE CODES FOR COMPONENTS  
 PERIMETER SEAL: SILICON 30 DUROMETER  
 HOUSING: DSM AKULON K-FHG6  
 TPA/CPA: PBT-GF30  
 7. SYSTEM TESTED USING ESB-MIL123-A WIRE.  
 8. DISCOLORATION AT THE HOLDING KNT LINES DOES NOT AFFECT PRODUCT PERFORMANCE.

22	0.50	34083-2003	RIGHT	TIN	22	E-1644-01	-	119-165				
22	0.50	34083-3003	LEFT	TIN	22	E-1644-01	-	119-165	PNK			
22	0.50	34081-2005	RIGHT	GOLD	22	E-1644-01	-	119-165				
22	0.50	34081-3005	LEFT	GOLD	22	E-1644-01	-	119-165				
20	0.75	34083-2002	RIGHT	TIN	18/20	E-1644-00	-	160-210				
20	0.75	34083-3002	LEFT	TIN	18/20	E-1644-00	-	160-210	GREEN			
20	0.75	34081-2004	RIGHT	GOLD	18/20	E-1644-00	-	160-210				
20	0.75	34081-3004	LEFT	GOLD	18/20	E-1644-00	-	160-210	GREEN			
18	1.0	34083-3002	RIGHT	TIN	18/20	E-1644-00	-	160-210				
18	1.0	34083-3002	LEFT	TIN	18/20	E-1644-00	-	160-210				
18	1.0	34081-2004	RIGHT	GOLD	18/20	E-1644-00	-	160-210				
18	1.0	34081-3004	LEFT	GOLD	18/20	E-1644-00	-	160-210				
16	1.5	34083-2001	RIGHT	TIN	14/16	E-1644-02	-	210-250				
16	1.5	34083-3001	LEFT	TIN	14/16	E-1644-02	-	210-250	YELLOW			
16	1.5	34081-2003	RIGHT	GOLD	14/16	E-1644-02	-	210-250				
16	1.5	34081-3003	LEFT	GOLD	14/16	E-1644-02	-	210-250				
14	1.5	34083-2001	RIGHT	TIN	14/16	E-1644-02	-	210-250				
14	1.5	34083-3001	LEFT	TIN	14/16	-	7158-3033-40	254-269	GRAY			
14	1.5	34081-2003	RIGHT	GOLD	14/16	-	7158-3033-40	254-269				
14	1.5	34081-3003	LEFT	GOLD	14/16	-	7158-3033-40	254-269				
AWG	METRIC	MOLEX	PAYOFF	PLATING	GRIP	OSR	P/PIN	YAZAKI	P/PIN	WIRE	OD	COLOR
WIRE	SIZE	PART	NUMBER	DIRECTION	TERMINAL	CABLE	SEAL					

INSPECTION NUMBER LOG  
 LAST NUMBER USED: 6  
 ADDED: 6  
 REMOVED:

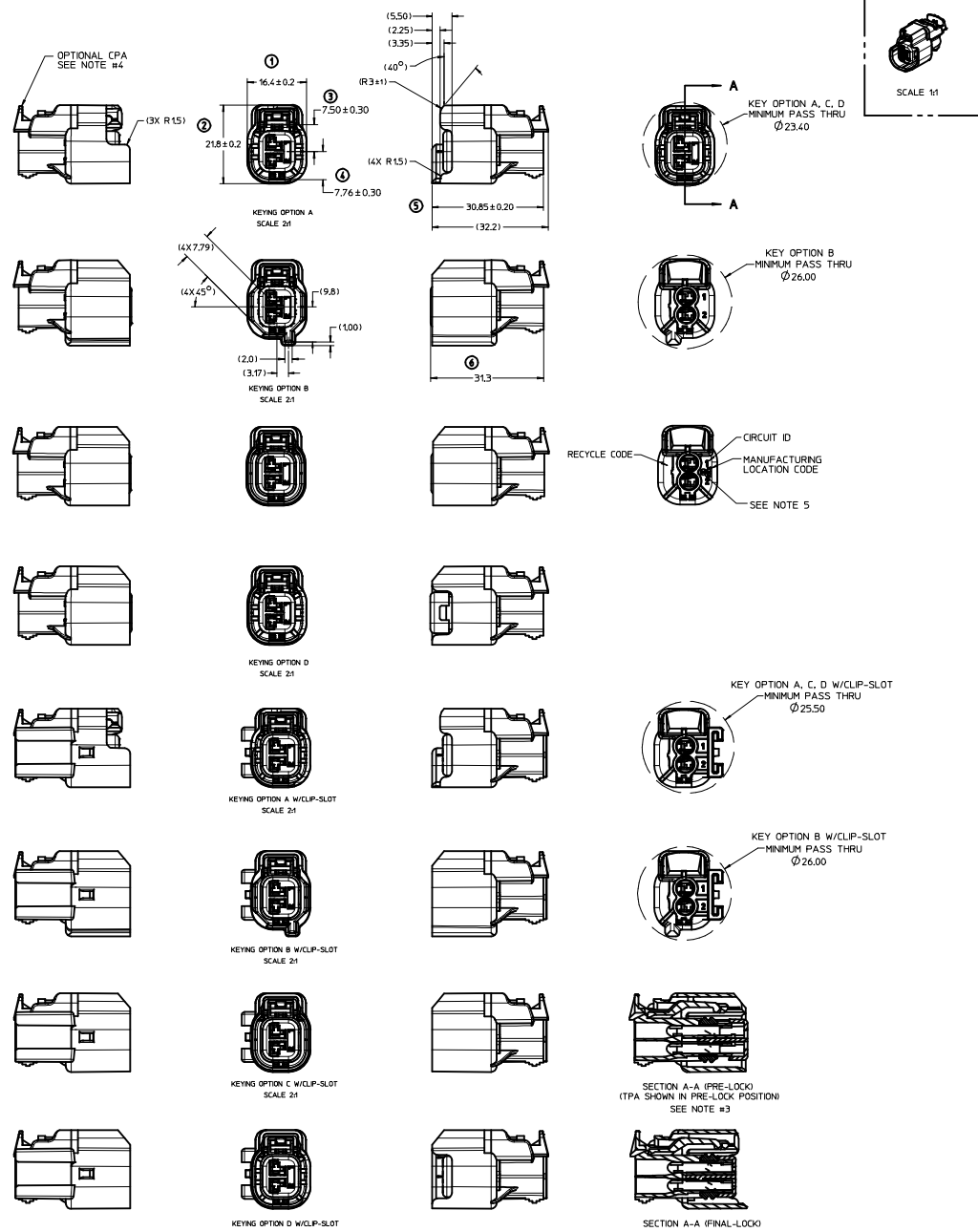

QUALITY SYMBOLS	GENERAL TOLERANCES (UNLESS SPECIFIED)		DIMENSION STYLE		SCALE	DESIGN UNITS	THIRD ANGLE PROJECTION
	mm	INCH	MM ONLY	DATE	2:1	METRIC	
▽=0	4 PLACES ±	±	DHZHANG	2007/03/16			
▽=0	3 PLACES ±	±	CHECKED BY	DATE			
	2 PLACES ±	±	DGRIFFITHS	2007/04/18			
	1 PLACE ±	±	APPROVED BY	DATE			
	ANGULAR ±	°	SMARCEAU	2007/04/18			
DRAFT WHERE APPLICABLE MUST REMAIN WITHIN DIMENSIONS		SEE CHART		DOCUMENT NO.		SHEET NO.	
		SD-34062-002		1 OF 1			

ENTER DESCRIPTION  
 EC NO: UAU0005-0706  
 IT DRAWING REF: THIS 2007/01/22  
 APPROXIM: THIS 2007/01/26

REVISIONS

GENERAL TOLERANCES (UNLESS SPECIFIED)

DIMENSION STYLE

SCALE 2:1  
 DESIGN UNITS METRIC  
 THIRD ANGLE PROJECTION  
 CONNECTOR ASSEMBLY  
 2-WAY FUEL 15MM FEMALE  
 FUEL INJECTOR CONNECTOR  
 MOLEX INCORPORATED